

2005 CORESTA study group meeting Stratford upon Avon

borgwaldt-kc

RM20S

**Smoke generator for in vitro
research**

Nils Rose

2005 CORESTA study group meeting Stratford upon Avon

borgwaldt-kc

Since KC-Automation is fully integrated into the Borgwaldt group, Borgwaldt-KC is supplier of:

- 3 rotary smoking machines**
- 4 linear smoking machines**

2005 CORESTA study group meeting

Stratford upon Avon

borgwaldt-kc

Rotary Machines:

- RM200
- RM20H
- RM20S

Linear Machines:

- LM20x
- LM5
- LM1
- LMC2, LMC4, LMC8

2005 CORESTA study group meeting Stratford upon Avon

borgwaldt-kc

2005_SSPT25_Rose_p.pdf

Routine analytical smoking

RM200



Fully automatic 20-port smoker
for 200 cigarettes

LM20x



20-channel smoker

2005 CORESTA study group meeting Stratford upon Avon

borgwaldt-kc

2005_SSPT25_Rose_p.pdf

Special analyses

RM20H



LM5



Semi automatic 20-port smoker for Hoffmann analyses and routine smoking

5-port smoker for side-stream analyses

SSPT2005 - Document not peer-reviewed by CORESTA

2005 CORESTA study group meeting Stratford upon Avon

borgwaldt-kc

2005_SSPT25_Rose_p.pdf

R&D machines

LM1



Single port smoker for R&D tasks, routine and side-stream analyses

LMC



2-,4- or 8-channel smoker for high versatile R+D tasks

SSPT2005 - Document not peer-reviewed by CORESTA

2005 CORESTA study group meeting Stratford upon Avon

borgwaldt-kc

RM20S

4-channel smoke generator for in vitro
research

2005 CORESTA study group meeting

RM20S 4-channel smoke generator

borgwaldt-kc

To satisfy the need of the tobacco industry for a fully automatic smoke generator for diluted smoke, the **RM20S** was developed in close cooperation with BAT Southampton.

2005 CORESTA study group meeting

RM20S 4-channel smoke generator

RM20S



The **RM20S** is designed as a fully automatic 4-channel rotary smoker.

The machine is based on the proven technology of the smoking machine **RM200** and **RM20H**.

Hood and airflow allows to smoke under ISO conditions.

2005 CORESTA study group meeting

RM20S 4-channel smoke generator

RM20S



The 4 channels are operating independently. It is possible to smoke 4 different brands of cigarettes concurrently with different puff parameter.

Smoke of each puff can be diluted up to 1:1,5 Mio.

2005 CORESTA study group meeting

RM20S 4-channel smoke generator

borgwaldt-kc

2005_SSPT25_Rose_p.pdf

RM20S



Changeable puff parameter:
Puff profile
Puff volume (5 – 140 ml)
Puff duration (up to 2 sec.)
Cigarette length (65-100 mm)
Lighting power (50-90W)

SSPT2005 - Document not peer-reviewed by CORESTA

2005 CORESTA study group meeting

RM20S 4-channel smoke generator

Smoking ring

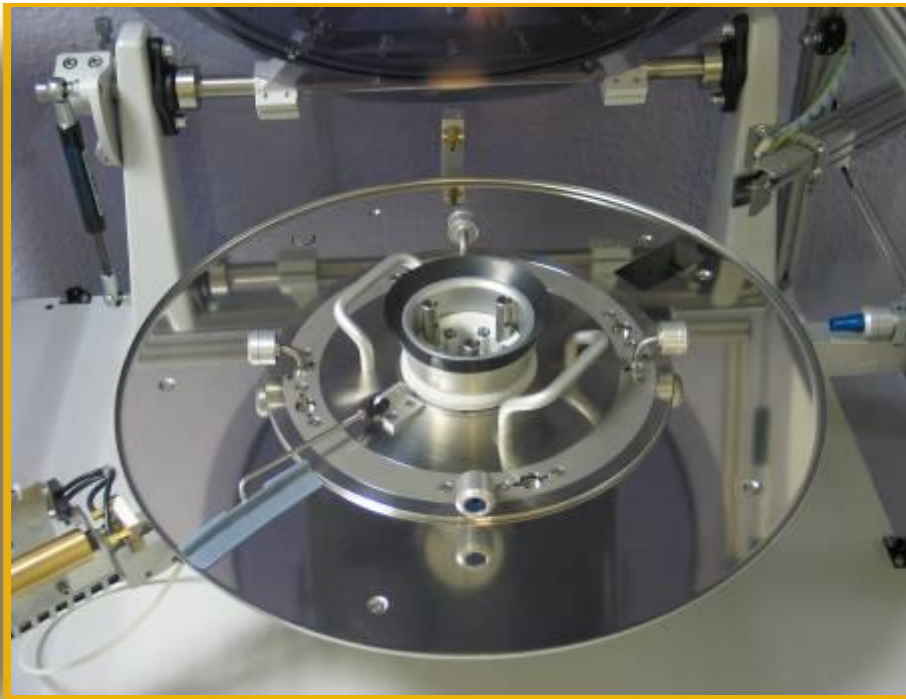

Cigarette holder for each of the 4 channels

Ventilation position for each channel

2005 CORESTA study group meeting

RM20S 4-channel smoke generator

Air flow guidance



Proven technology based
on the RM200/20H family
Unmodified air flow

2005 CORESTA study group meeting

RM20S 4-channel smoke generator

borgwaldt-kc

2005_SSPT25_Rose_p.pdf

Air flow guidance

Hinged unit to gain optimal access

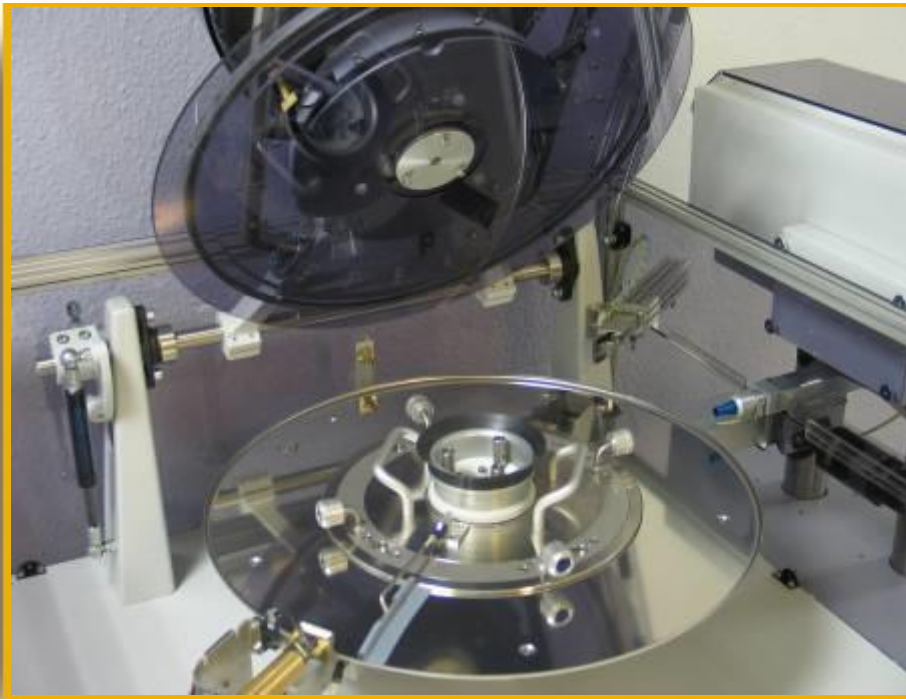

SSPT2005 - Document not peer-reviewed by CORESTA

2005 CORESTA study group meeting

RM20S 4-channel smoke generator

borgwaldt-kc

2005_SSPT25_Rose_p.pdf

Air flow guidance

Quick out air flow guide for easy maintenance and cleaning

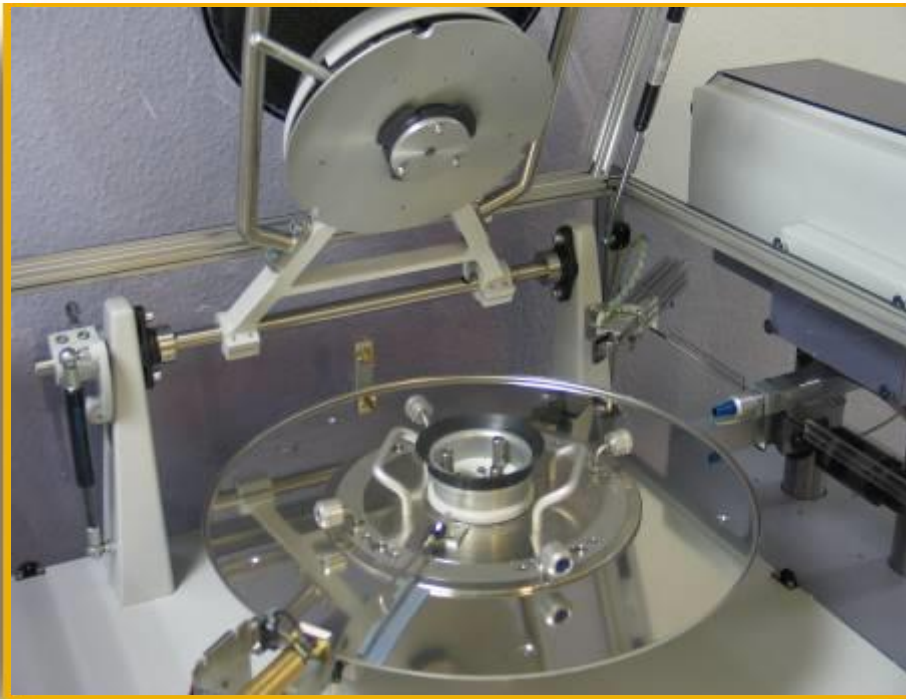

2005 CORESTA study group meeting

RM20S 4-channel smoke generator

Cassette Magazin

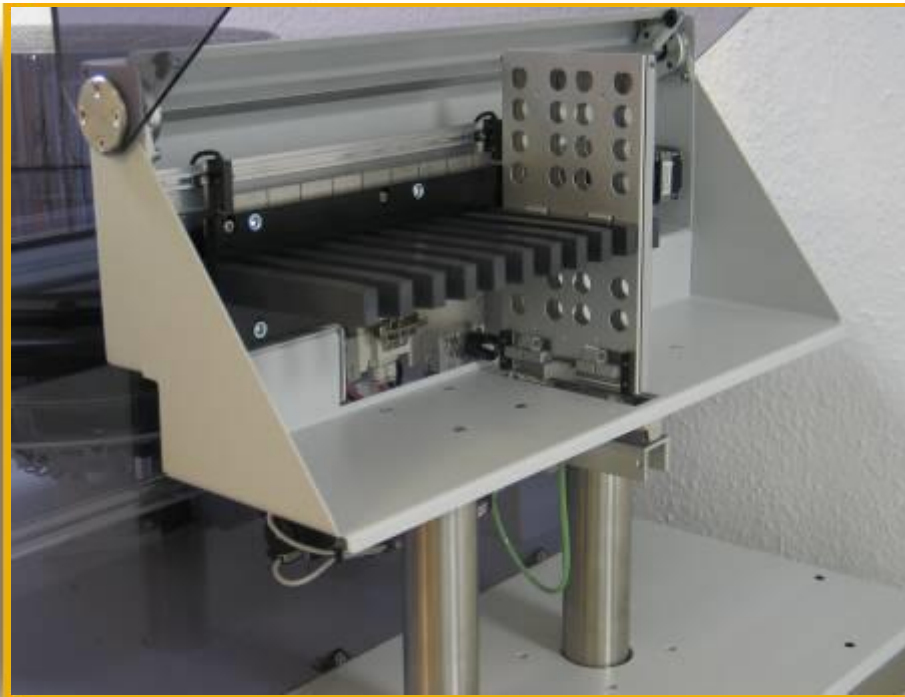

Capacity for 8 cassettes with 20 cigarettes each.

Empty cassettes can be replaced during the smoke run

2005 CORESTA study group meeting

RM20S 4-channel smoke generator

borgwaldt-kc

2005_SSPT25_Rose_p.pdf

Cassette Magazin

Cigarette separation
integrated into each cassette



2005 CORESTA study group meeting

RM20S 4-channel smoke generator

borgwaldt-kc

2005_SSPT25_Rose_p.pdf

Loading unit

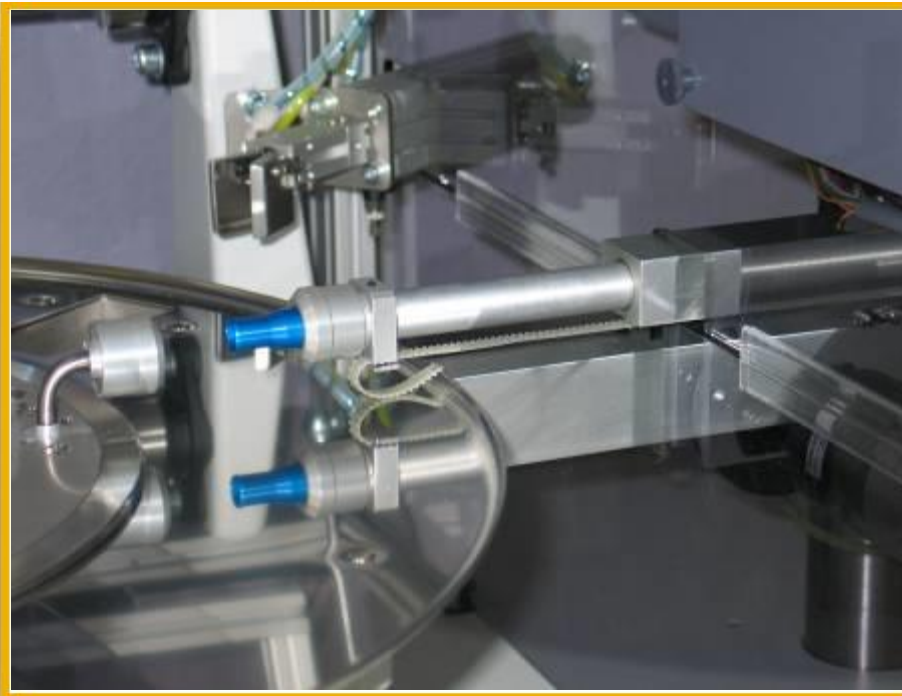

Directly mounted to the central unit

Contactless loading using air and vacuum to treat the cigarette with maximum care

The seals are opened with the tip of the nozzle

2005 CORESTA study group meeting

RM20S 4-channel smoke generator

Lighter

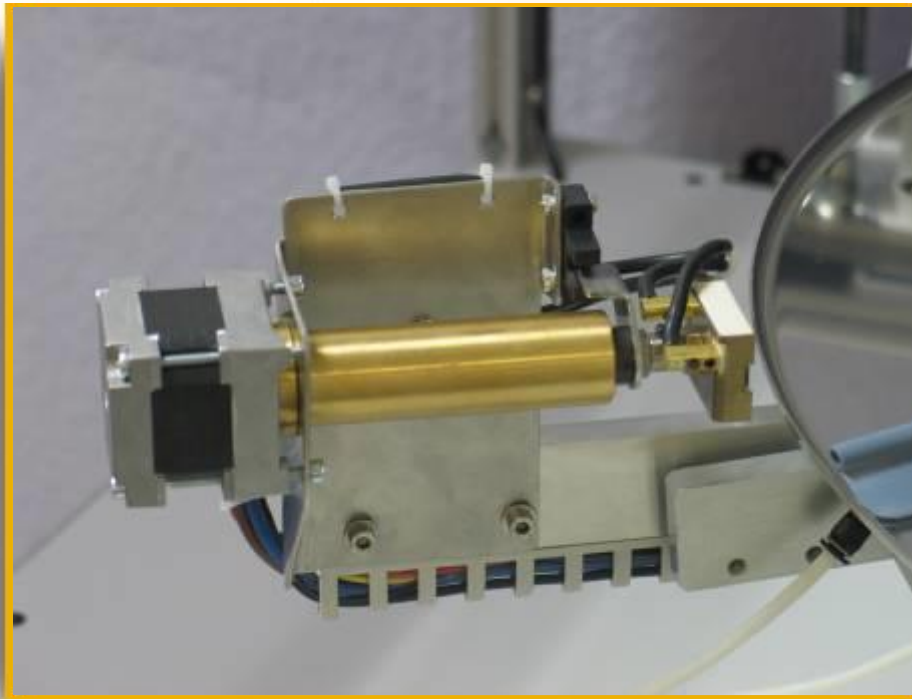

The Borgwaldt standard lighter element is used.

Stepper motor driven actuator.

The lighter element radiates power between 50W and 90W.

The power is determined by measuring voltage and current.

Lighting power is software controlled and can be altered in steps of 1W.

2005 CORESTA study group meeting

RM20S 4-channel smoke generator

borgwaldt-kc

2005_SSPT25_Rose_p.pdf

Butt length detector

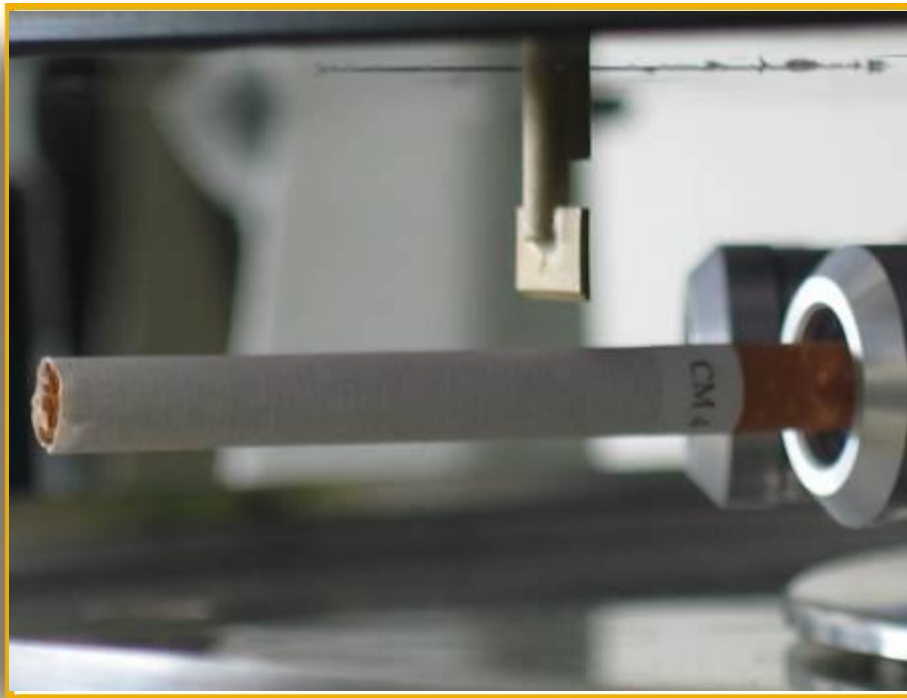

For higher accuracy, smoking is terminated by an infrared butt length control (BLC).

2005 CORESTA study group meeting

RM20S 4-channel smoke generator

Butt length detector



The BLC is a further development of the Borgwaldt standard BLC.

It is mounted onto the pivoting frame of the air flow guidance.

The unit is driven by a powerful stepper motor for exact positioning.

2005 CORESTA study group meeting

RM20S 4-channel smoke generator

Syringe assembly



The 4 channels are operating independently
Mounted on a swivelling frame to gain optimal access

2005 CORESTA study group meeting

RM20S 4-channel smoke generator

Syringe assembly

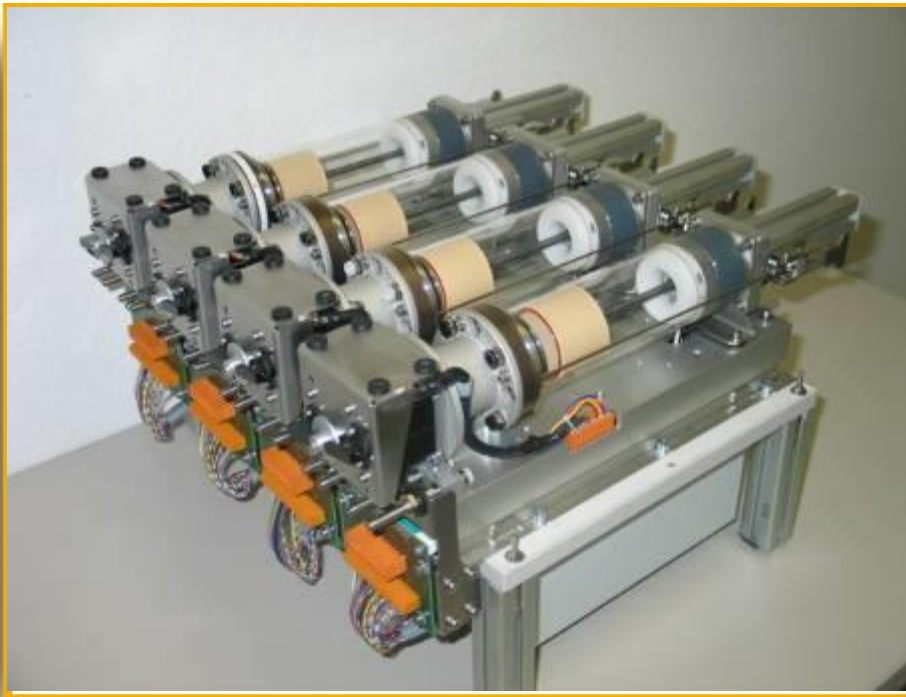

The syringe system is designed as a cassette installation.

2005 CORESTA study group meeting

RM20S 4-channel smoke generator

Syringe assembly

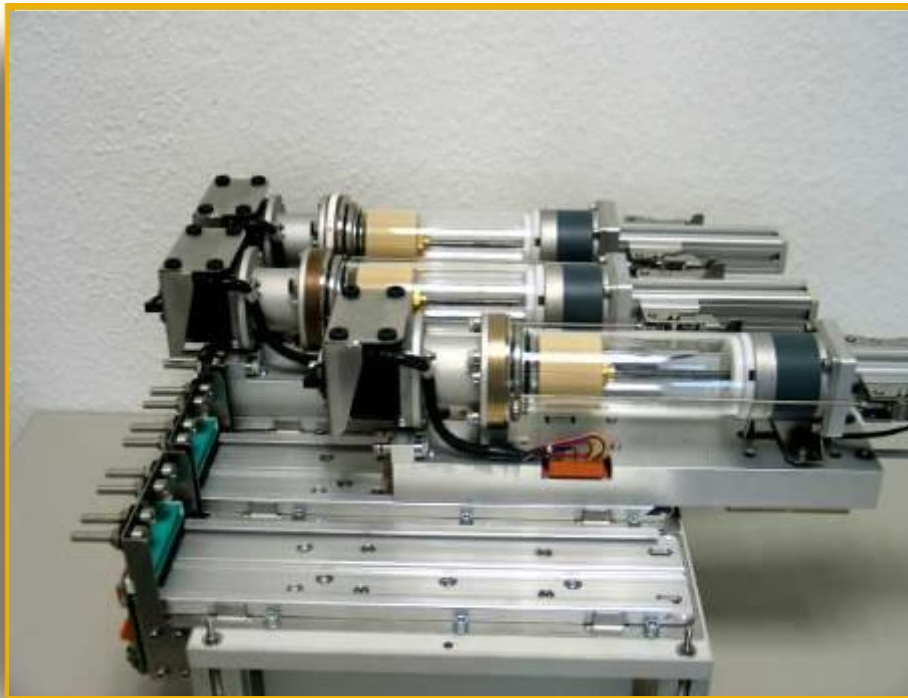

The complete operational unit is mounted on a sliding keyway.

It can be disconnected and withdrawn as a single module in an instant.

2005 CORESTA study group meeting

RM20S 4-channel smoke generator

Syringe assembly



Service and maintenance of the syringe can then be carried out on the bench top.

2005 CORESTA study group meeting

RM20S 4-channel smoke generator

Syringe assembly

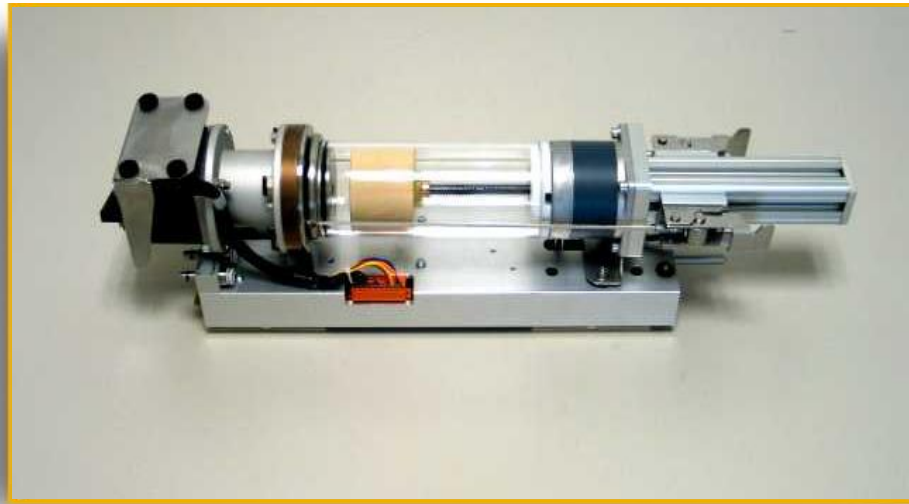

The syringe is stepper motor driven.
It can replicate different puff profiles.
10 Puff profiles are pre designed.
9 of these profiles can be modified.

2005 CORESTA study group meeting

RM20S 4-channel smoke generator

Syringe assembly

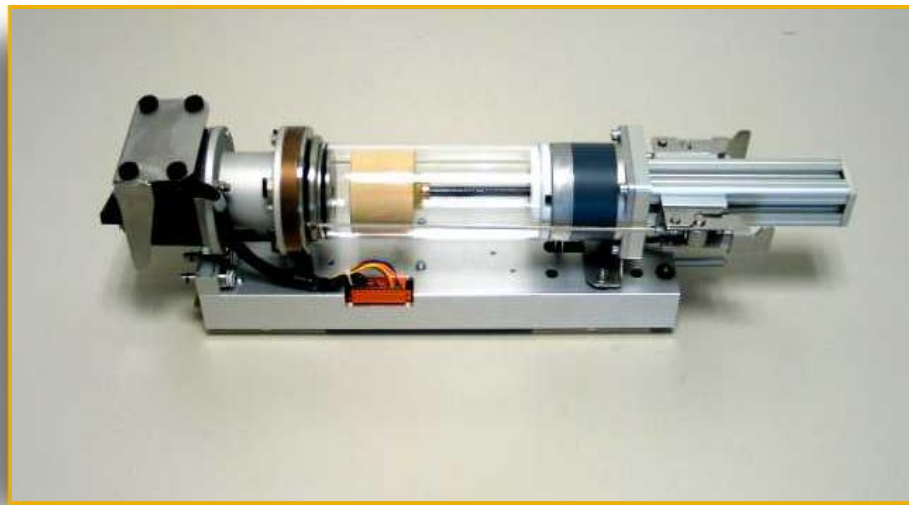

Data of the syringe:

Piston speed: 0,1 - 80 mm/s = 6 - 4800 mm/min

Flow rate: 0,2 - 157 ml/s = 12 - 9420 ml/min

Puff volume : <5 - 140ml at 2 sec puff duration

Valve assembly

To direct the gas phase within a smoking machine, standard valves, designed for pneumatic applications are commonly used.

Not being designed for this purpose, these valves need a lot of attention and are a constant source for failure and service.

If whole smoke needs to be directed, commercially available valves cannot provide the security and reliability of operation that is required.

The valve needs to be of a chemically inert material.

2005 CORESTA study group meeting

RM20S 4-channel smoke generator

Valve assembly

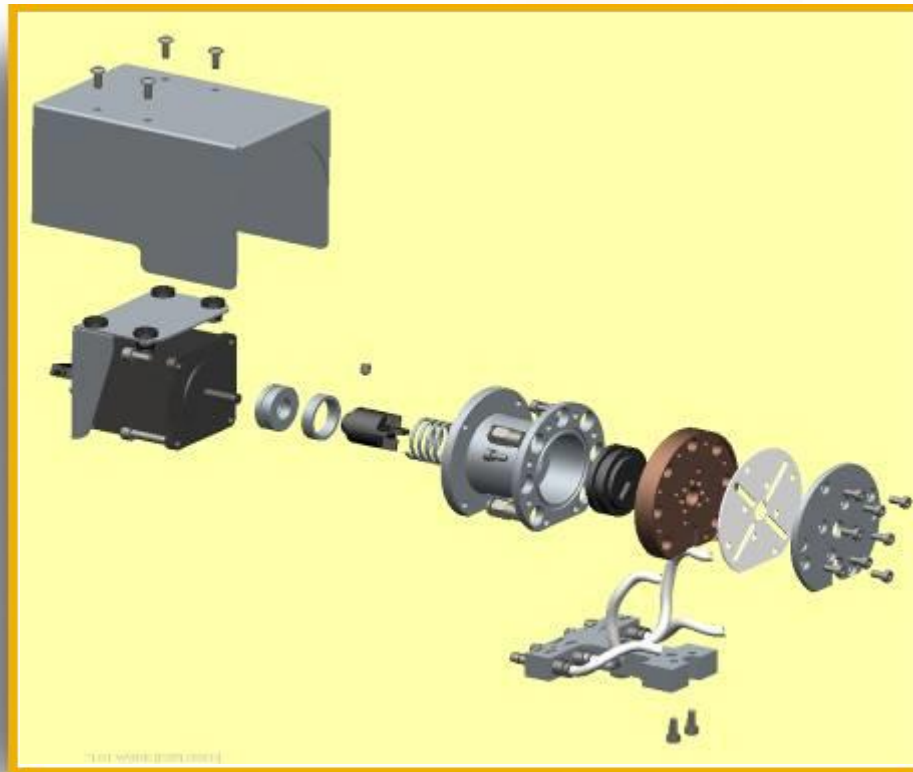

New developed rotary 5/4 way valve for this special application.
Stepper motor driven valve disc.

2005 CORESTA study group meeting

RM20S 4-channel smoke generator

Valve assembly

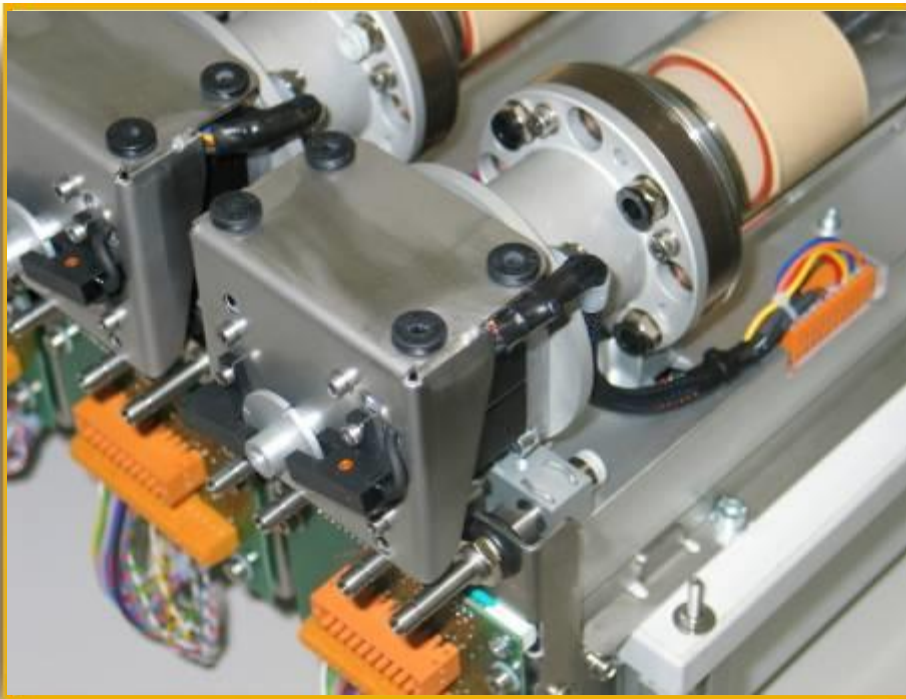

Operating directly at the head of the syringe assembly.
Low impedance.
Minimal dead volume.

2005 CORESTA study group meeting

RM20S 4-channel smoke generator

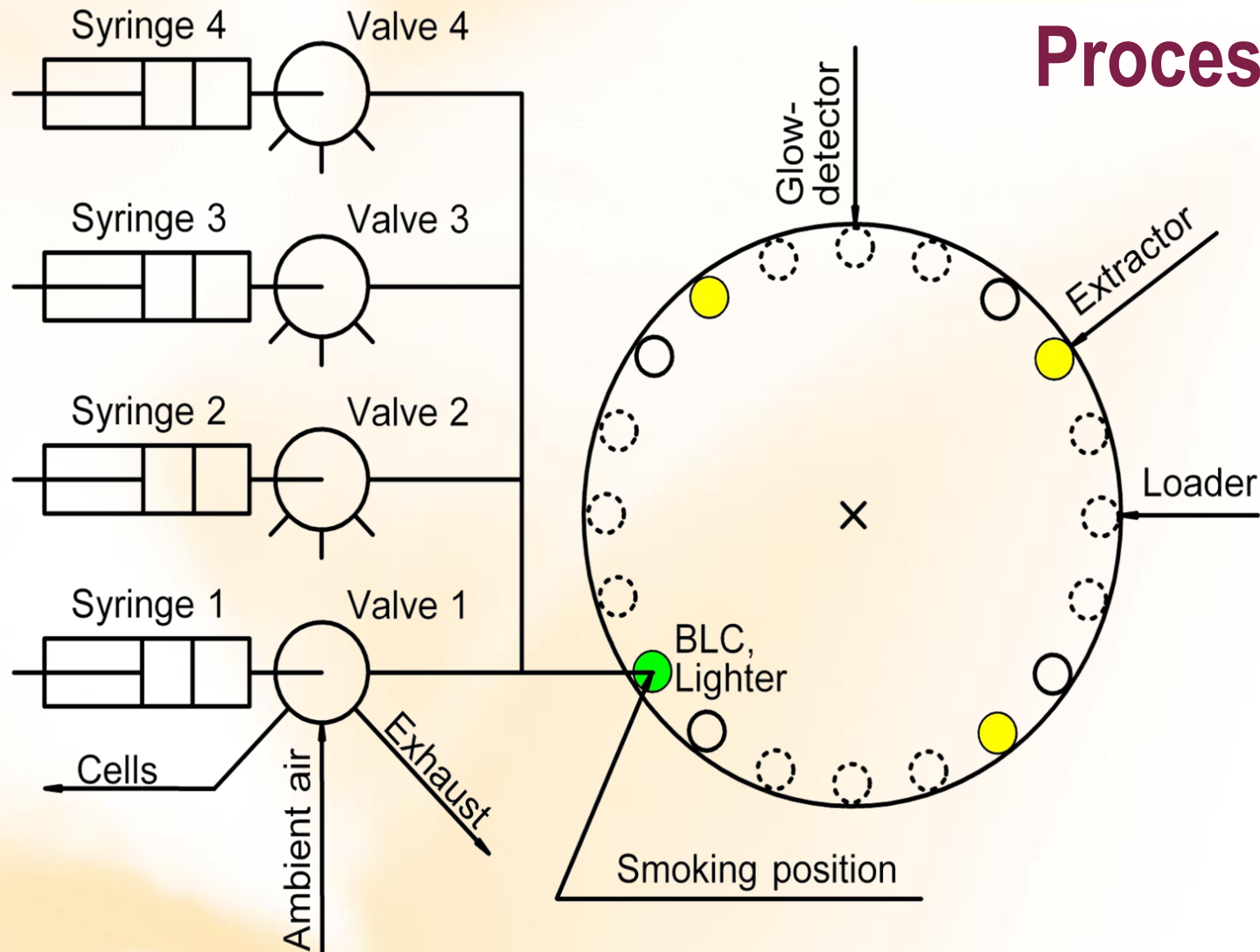

Process flow

2005 CORESTA study group meeting

RM20S 4-channel smoke generator

Smoking

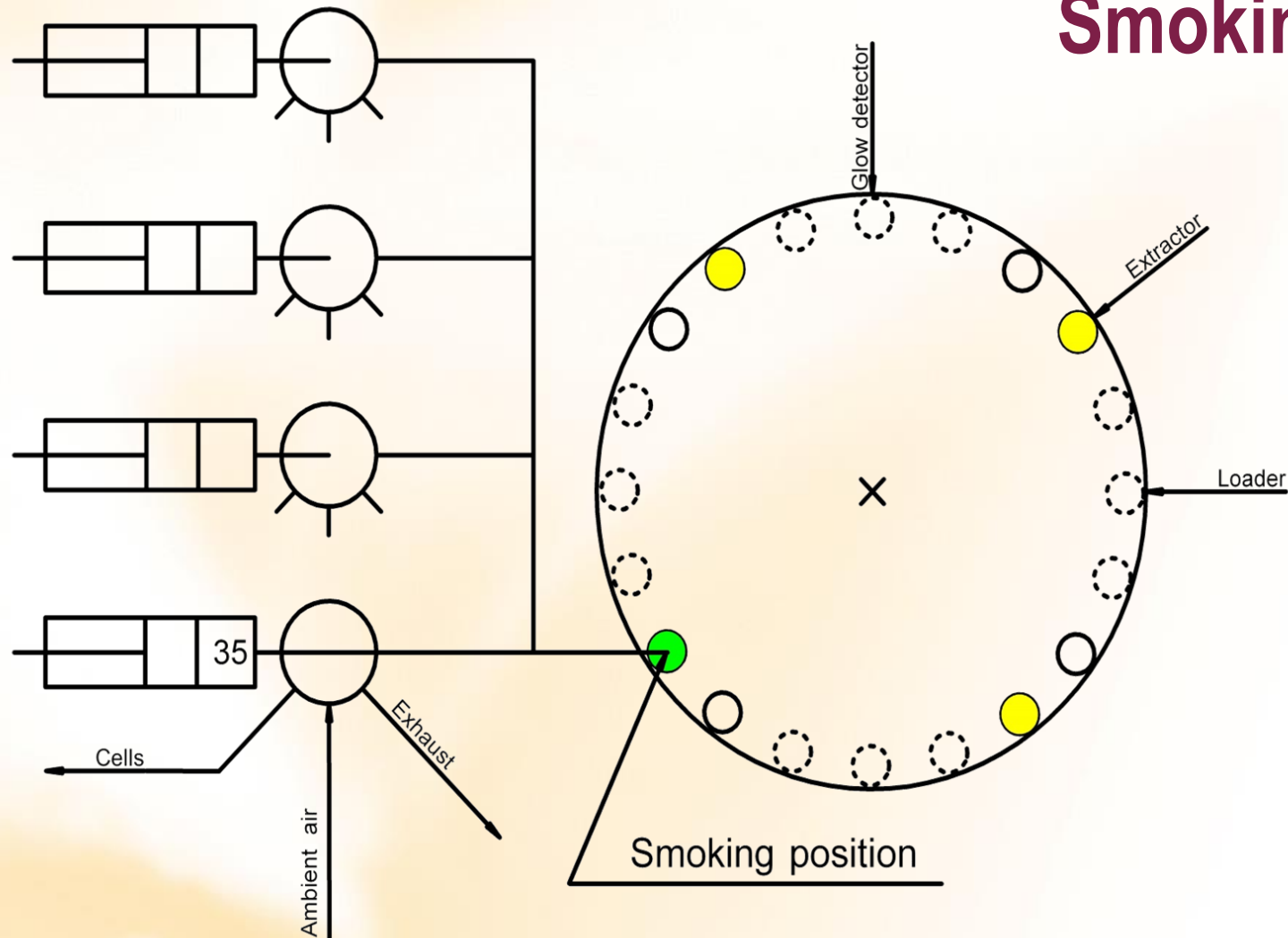

2005 CORESTA study group meeting

RM20S 4-channel smoke generator

Flushing

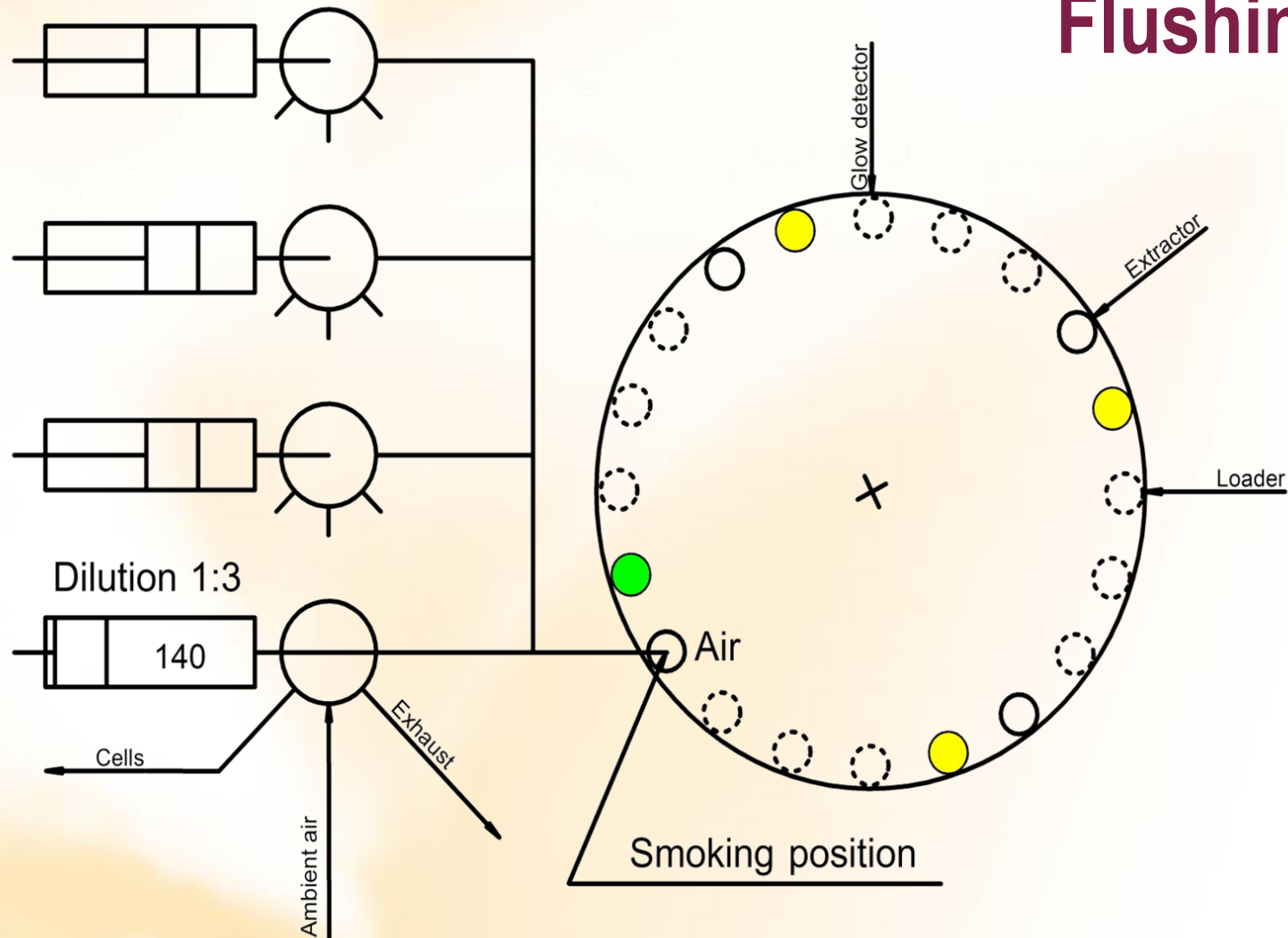

2005 CORESTA study group meeting

RM20S 4-channel smoke generator

Diluting

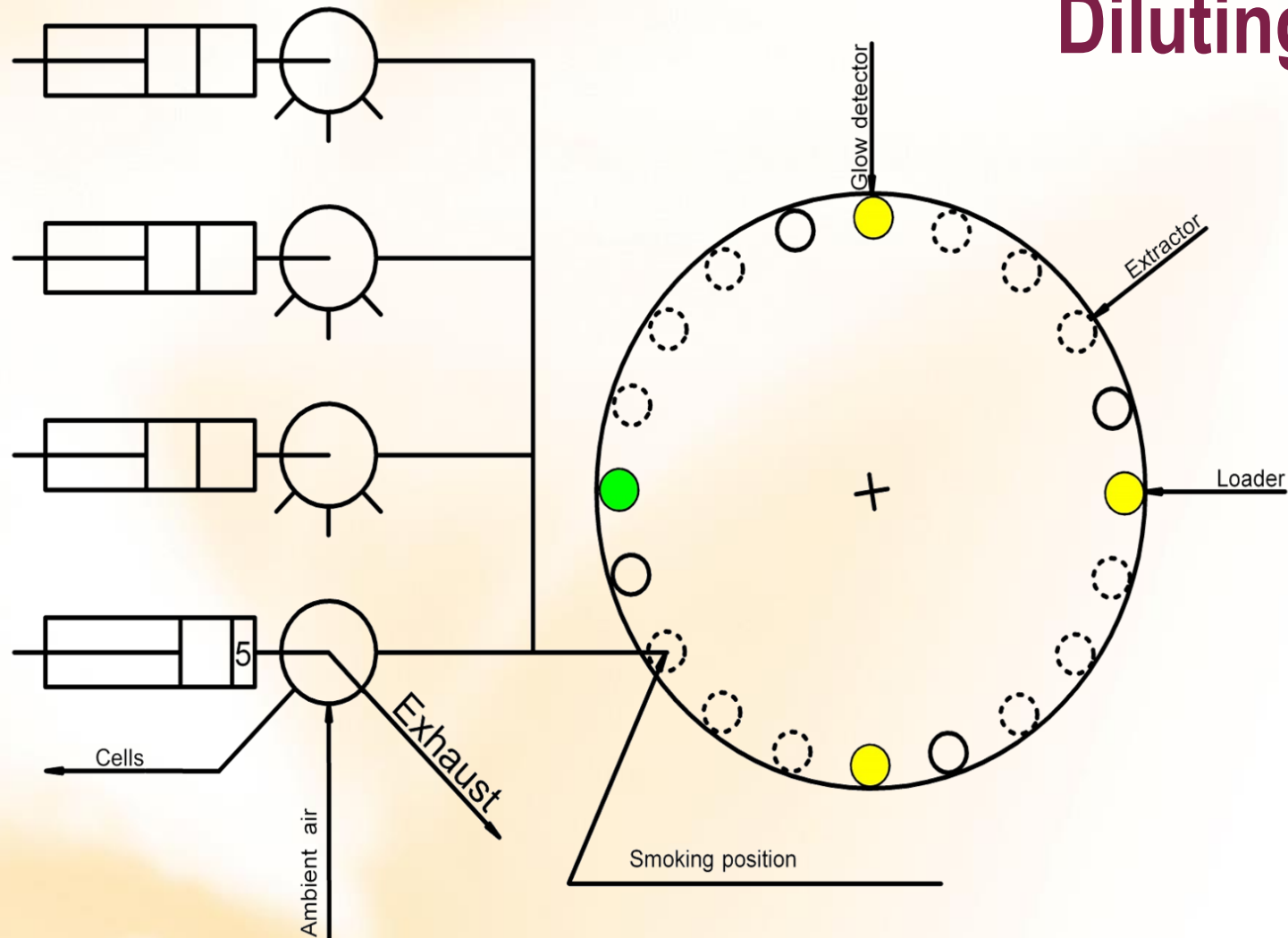

2005 CORESTA study group meeting

RM20S 4-channel smoke generator

Diluting

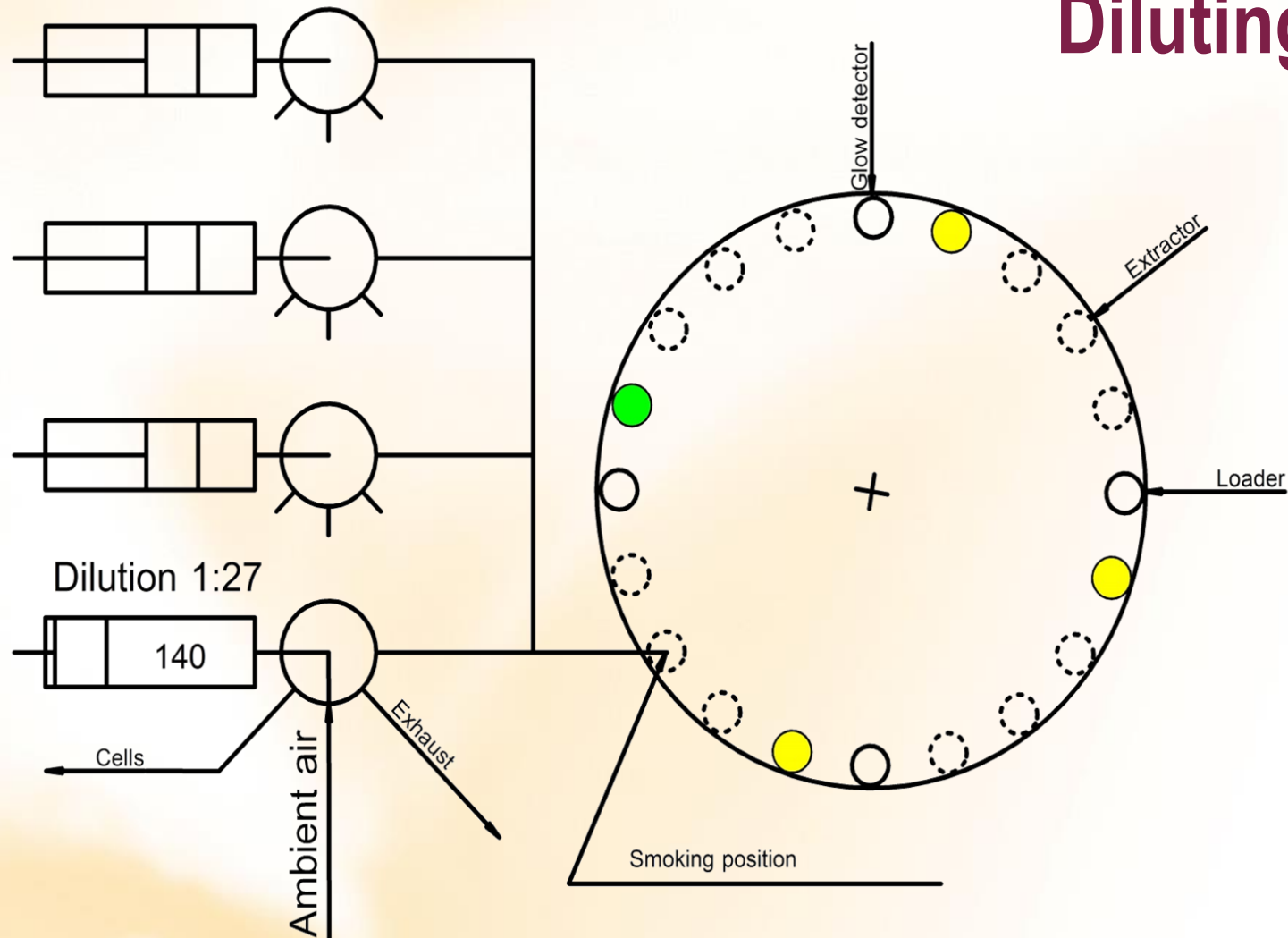

2005 CORESTA study group meeting

RM20S 4-channel smoke generator

borgwaldt-kc

Gassing

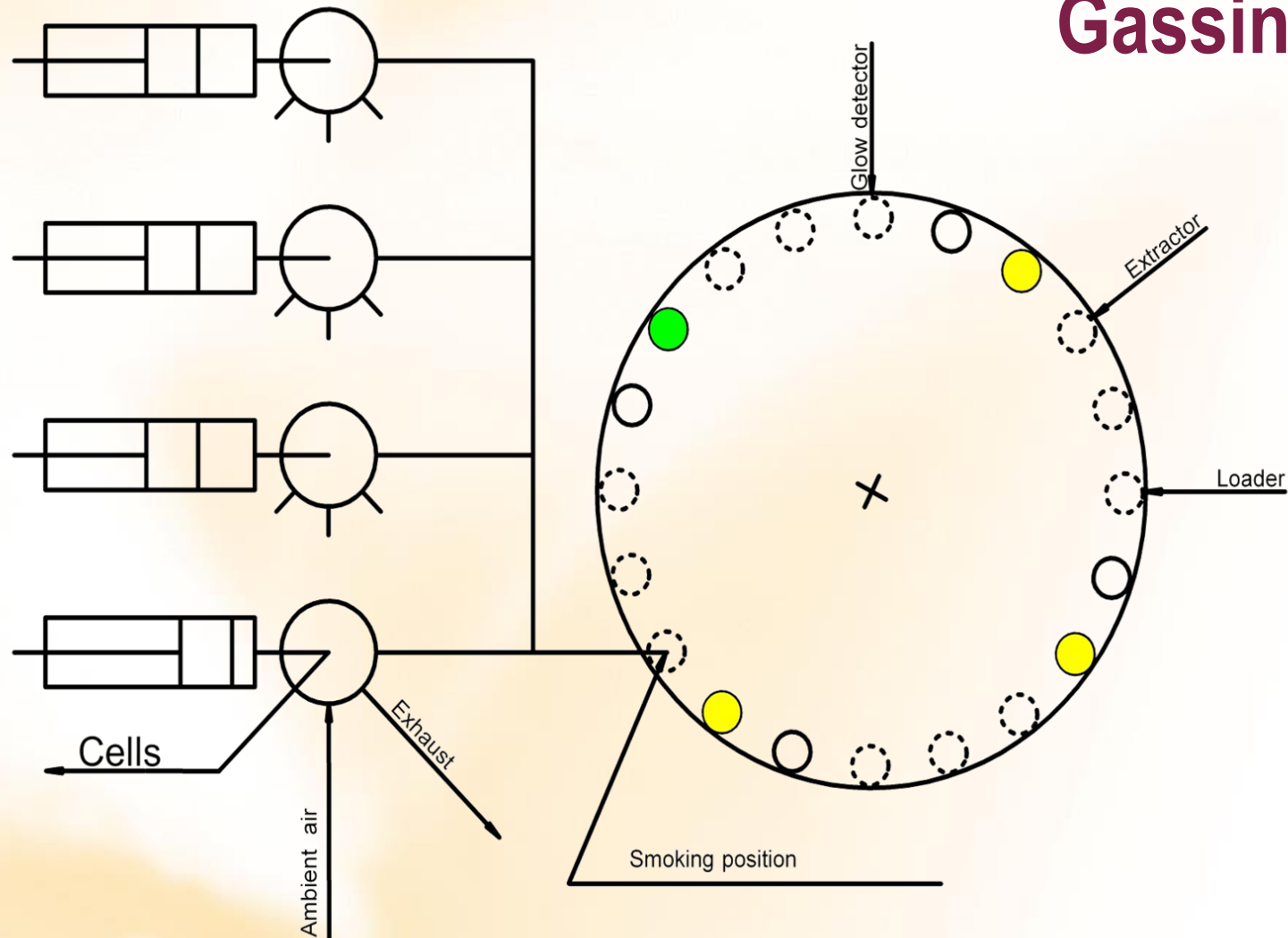

2005 CORESTA study group meeting

RM20S 4-channel smoke generator

borgwaldt-kc

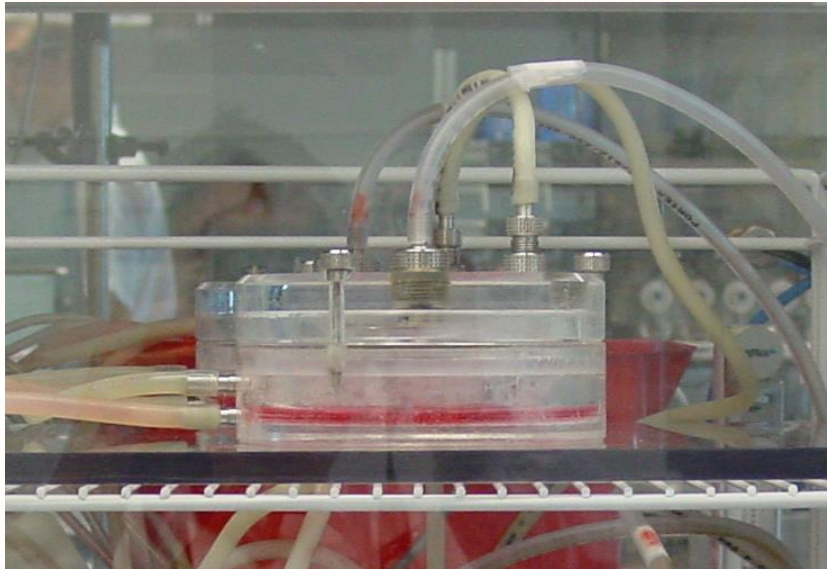

Cell chamber



Incubator

2005 CORESTA study group meeting

RM20S 4-channel smoke generator

Conclusion:

- The RM20S is a highly versatile smoke generator for the in vitro research work.
- Due to the fact, that the machine is based on the technology of the RM200/20H the machine can smoke under ISO conditions.
- All 4 channels operate independently.
- Different brands can be smoked concurrently with different puff parameters.
- A smoke dilution up to 1:1,5 mio is possible.

2005 CORESTA study group meeting

RM20S 4-channel smoke generator

borgwaldt-kc

Many thanks for your attention

For more information please contact us:

Contact	Borgwaldt Technik GmbH Schnackenburgallee 15 D-22525 Hamburg, Germany
Web	www.borgwaldt.de
Mail	BT@borgwaldt.de
Phone	+49 - (0)40 - 85 31 38 0
Fax	+49 - (0)40 - 85 05 60 0

2005 CORESTA study group meeting Stratford upon Avon

borgwaldt-kc

RM20S

**Smoke generator for in vitro
research**